

Assembly instruction side pillar 33B172

List of parts of all variations of side pillar 33B172

No.	Name	Index
1.	Body pillar	33B172
2.	Telescope – moving roof	33B176_1902
3.	Telescope – fix roof	33B176_1602
4.	Pillar grip	33B174_1 33B174_2
5.	Board pocket 400	33B161
6.	Board pocket universal	327013_A3
7.	Telescope bracket part 1	33B180_1
8.	Telescope bracket part 2	33B180_2
9.	Telescope slide lock	33B180_3
10.	Expander	33B178

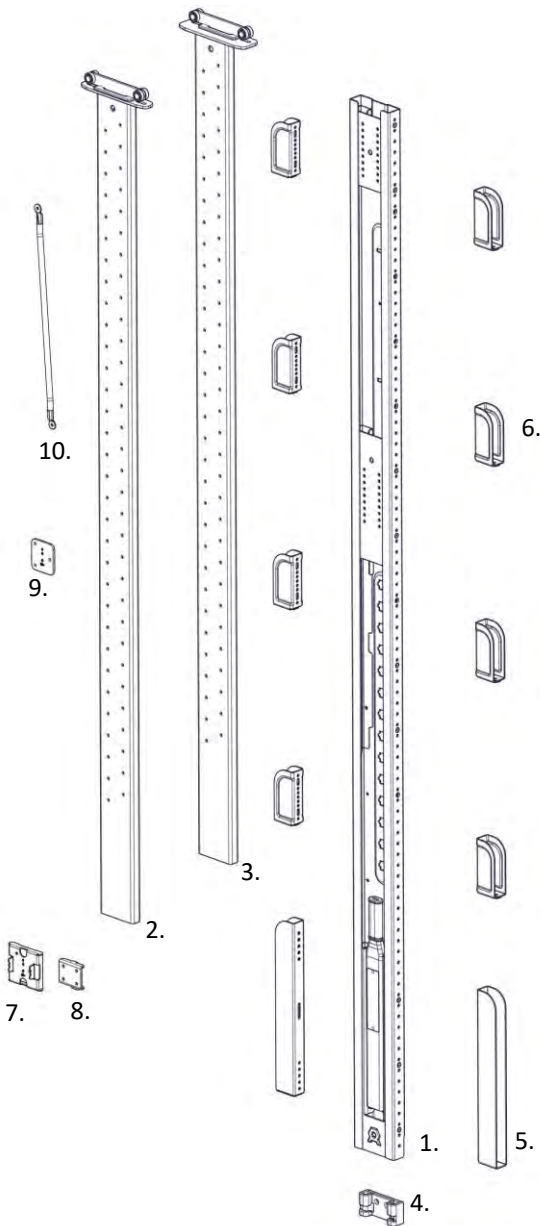

- ① Curtain trailer - moving roof
- ② Semi-side trailer – moving roof
- ③ Curtain trailer – fix roof

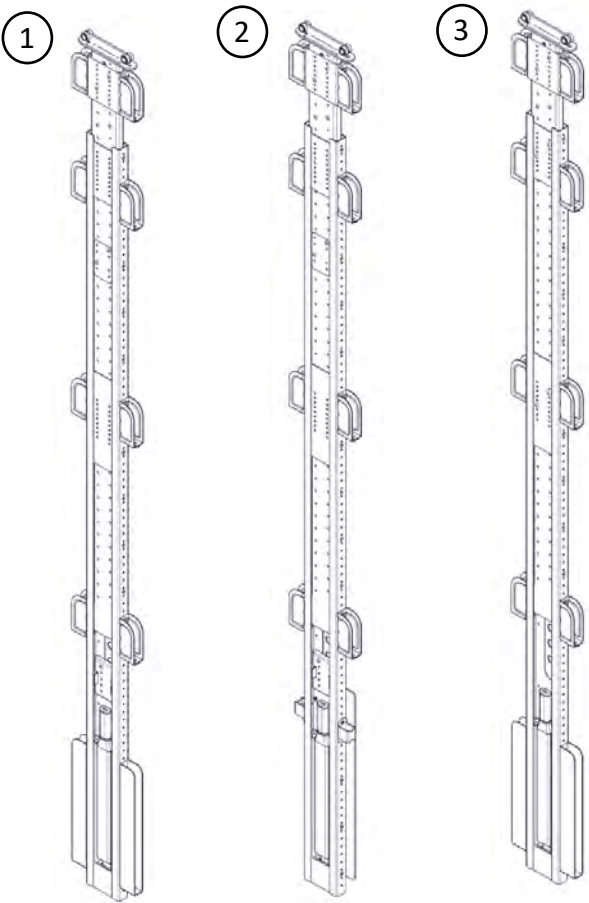

1. Assembly of pillar grip

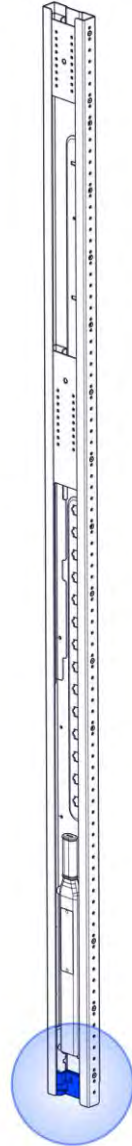

33B172

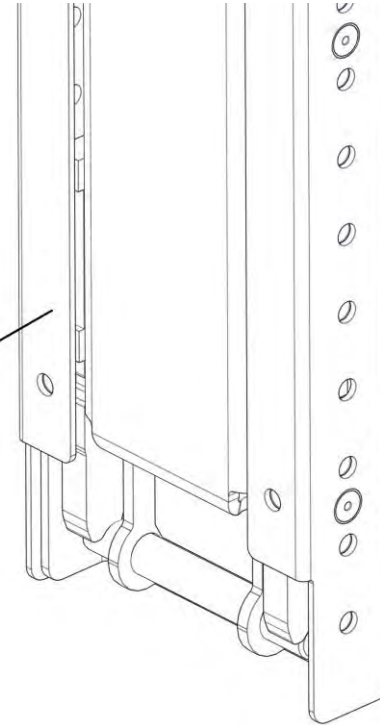

33B174_1 | 33B174_2

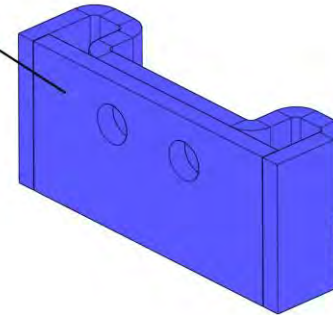

2. Fixing telescope with expander and pillar body – moving roof

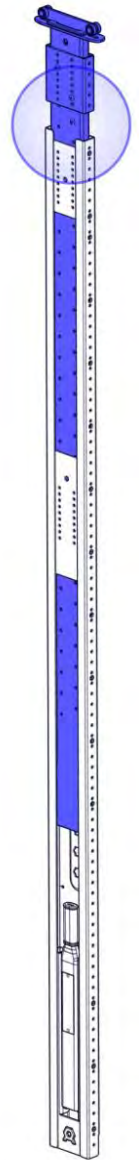

1

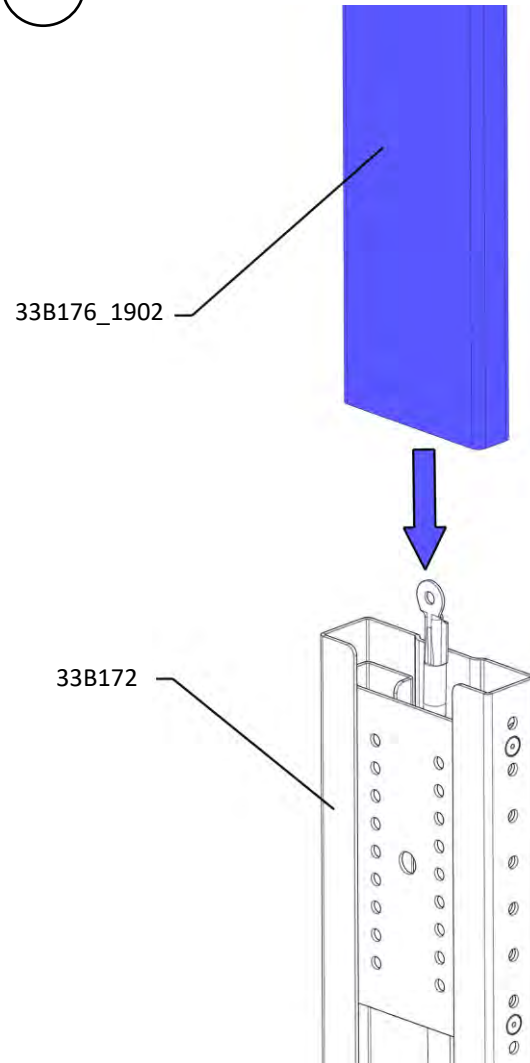

2

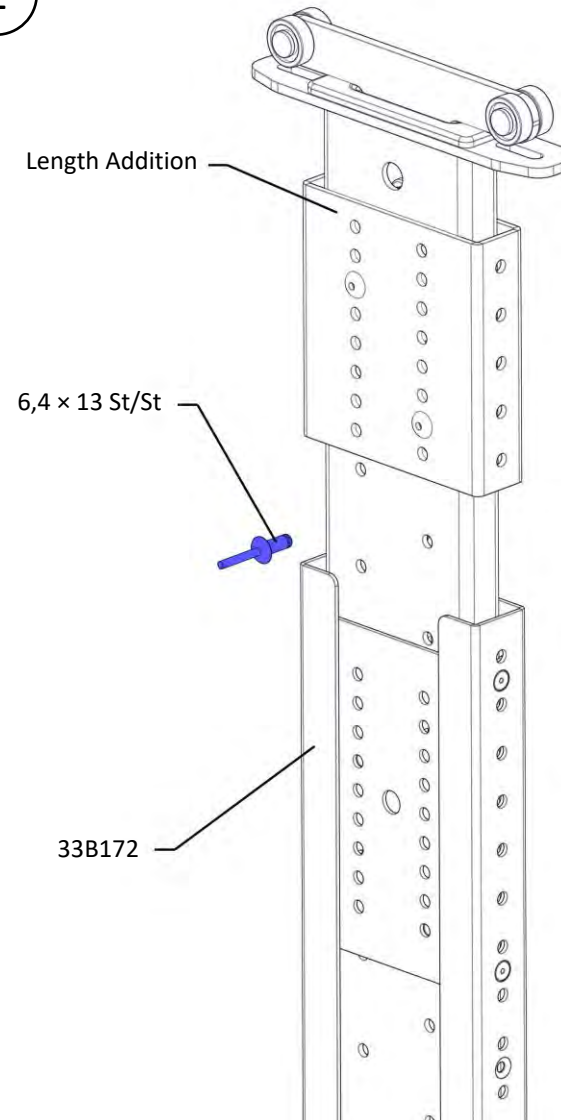

3

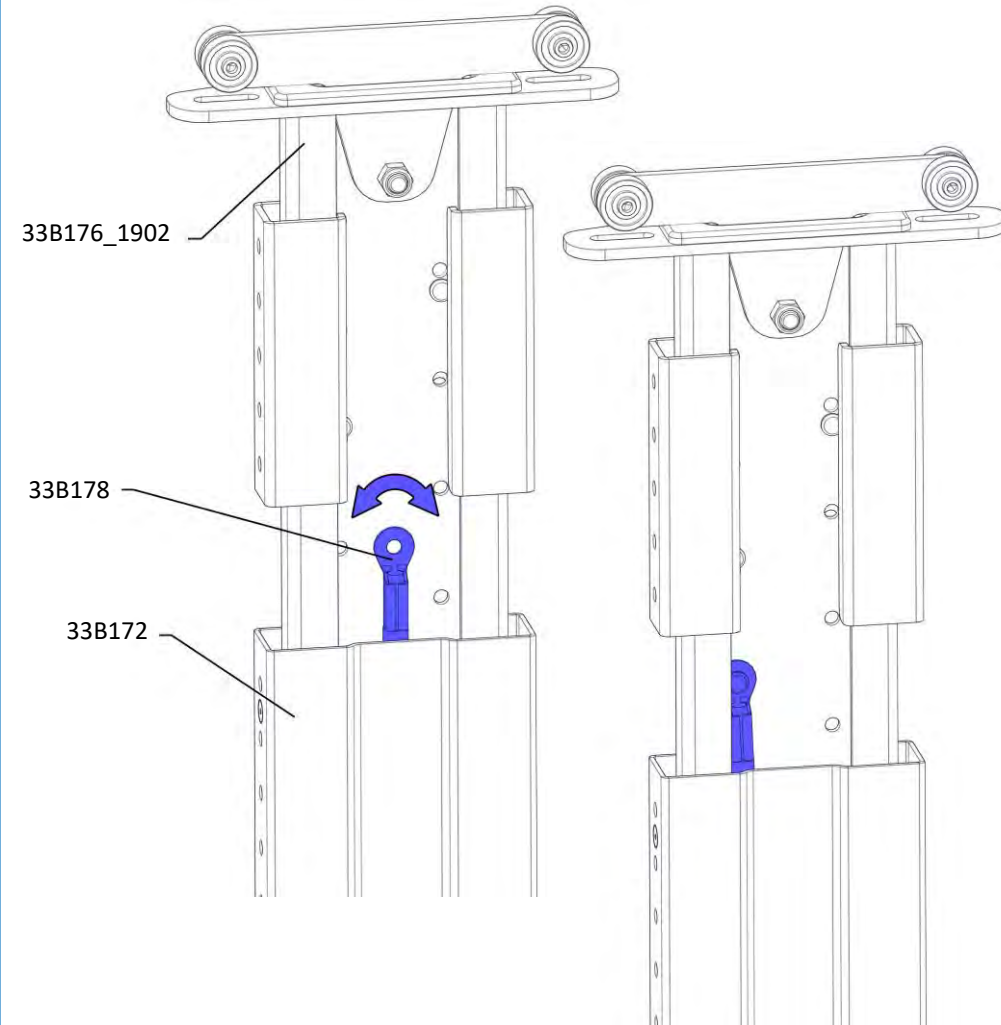

3. Assembly of telescope slide lock –moving roof

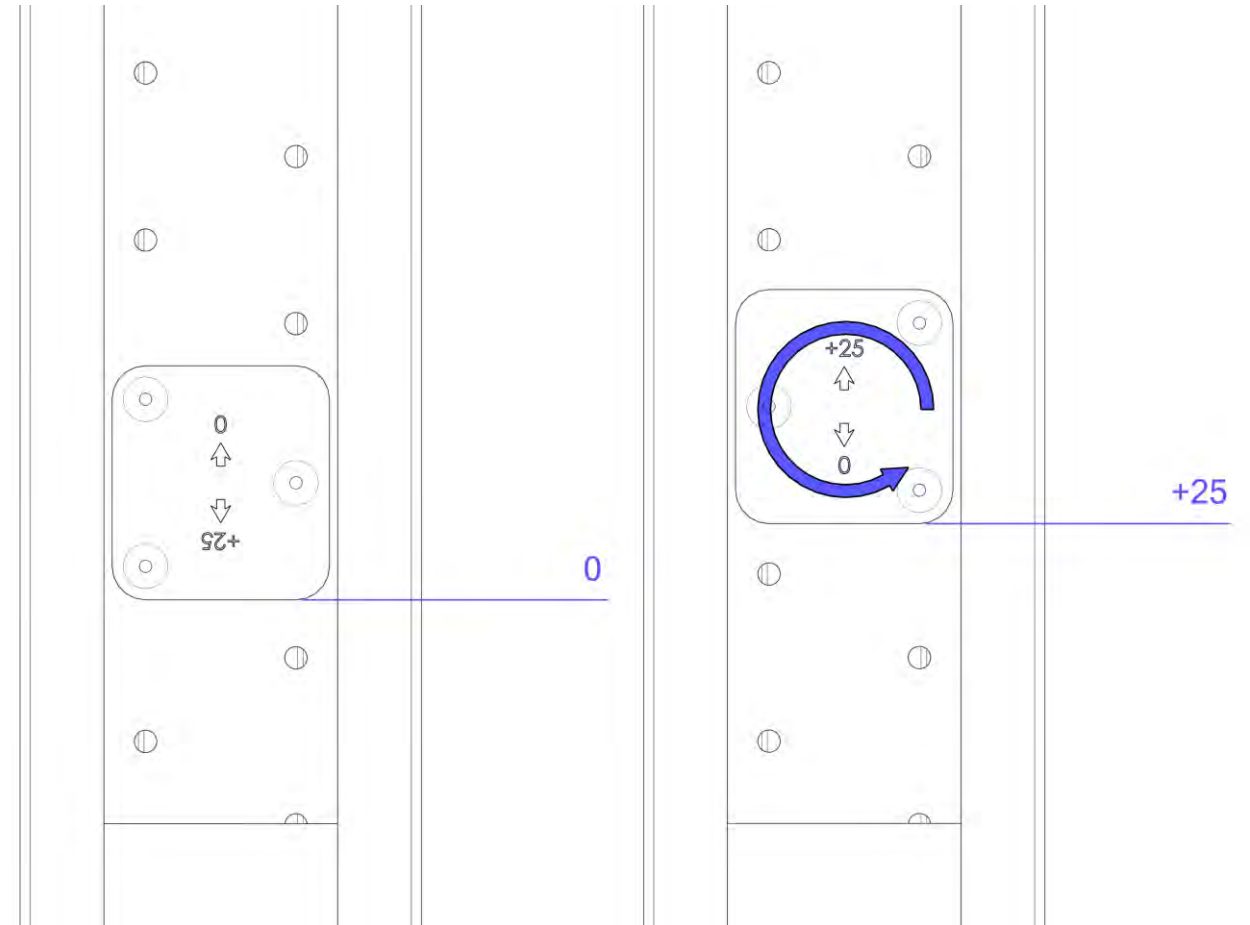
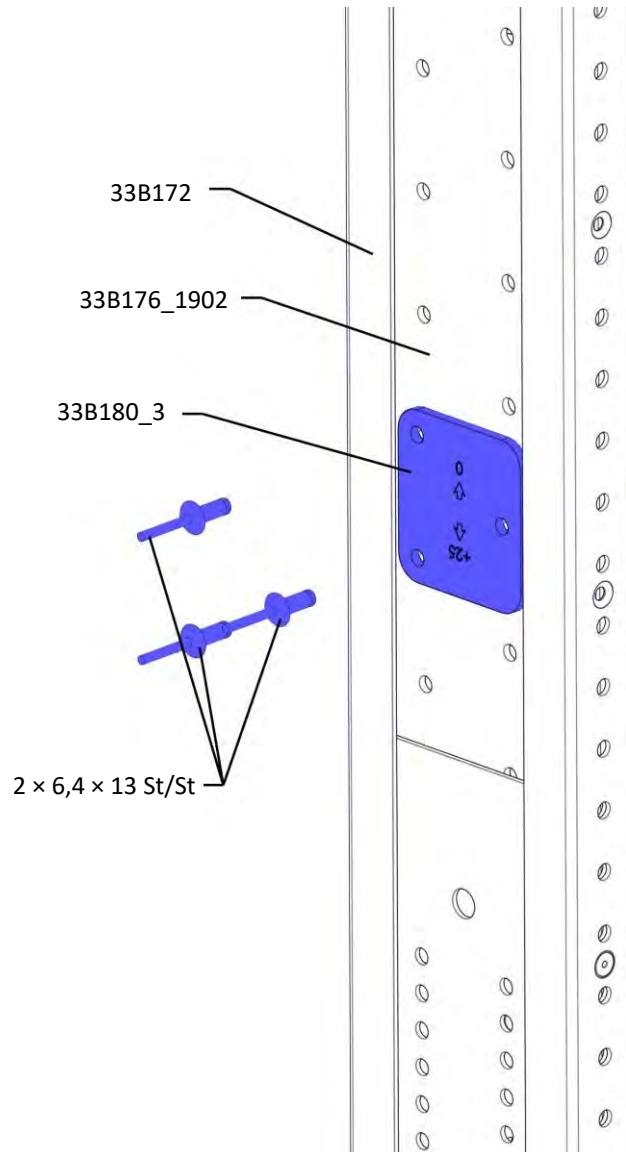
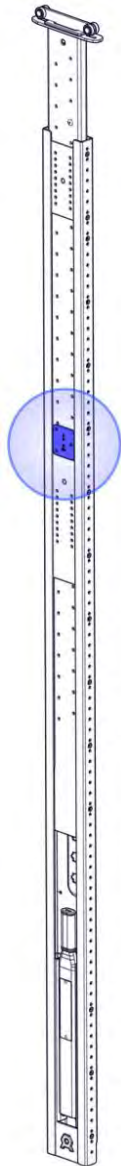

The height of the telescope is adjusted every 25mm by turning + moving the slide lock.

4a. Assembly of telescope bracket part 1 and 2

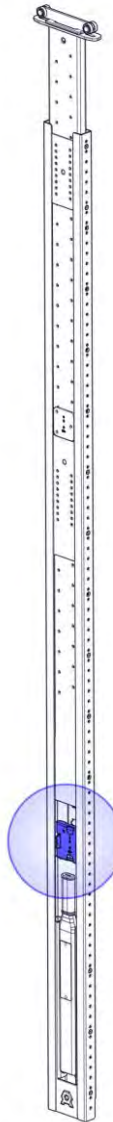

1

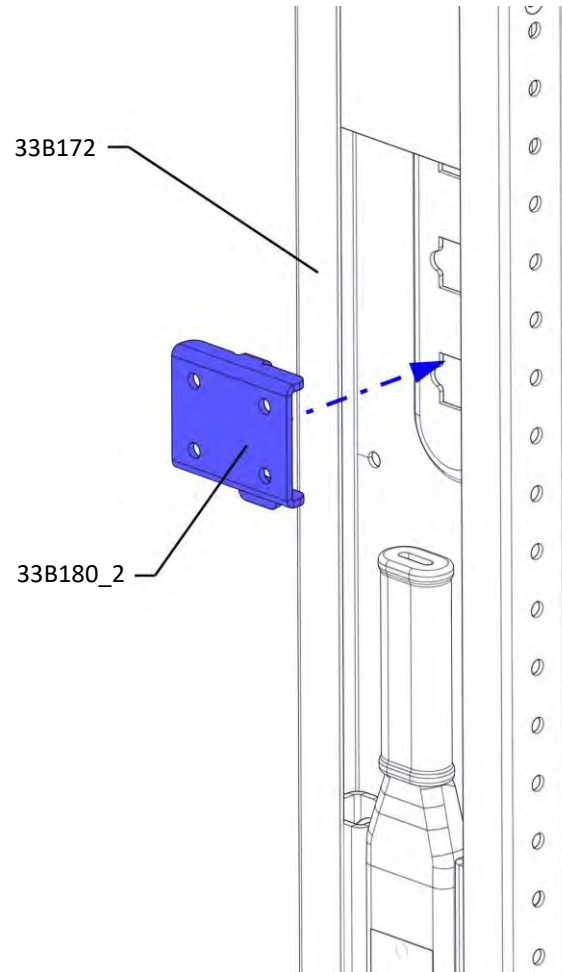

2

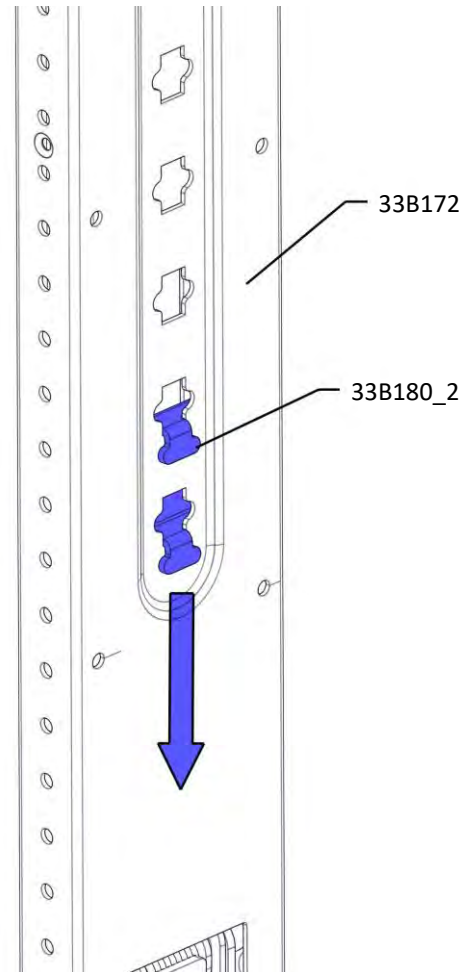

3

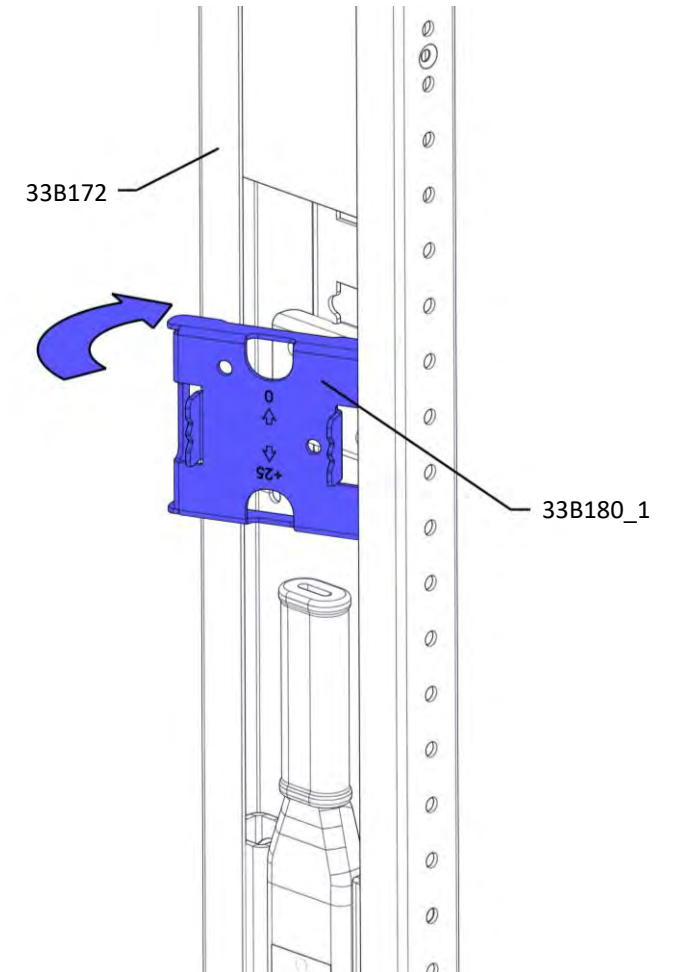

4b. Assembly of telescope bracket part 1 and 2

4

33B172

33B180_1

2 × 6,4 × 13 St/St

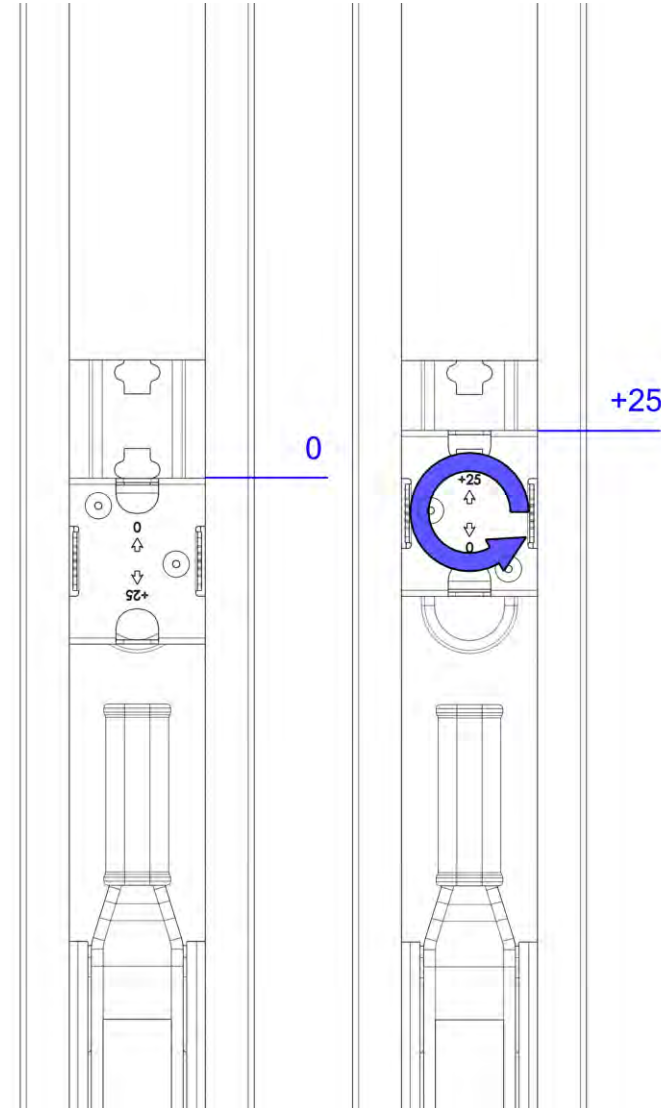

+25

0



The height of the telescope is adjusted every 25mm by turning + moving the telescope bracket part 1.